

Addendum #1



Project Information

Project Name: T-Bone Spillway

Bid Number: F24-09-079

Date: September 23, 2024

Project Manager: Mary Mateo

Addendum Questions

Question #1 Please confirm the contract is adding 8' to each side of the existing weir? Are we lengthening or widening that area?

Answer

The project is to add a 5' wide concrete slab along each side of the existing weir wall. This will create a drivable surface, approximately 10' – 8" wide along the length of the weir wall, which is approximately 166' long. See Exhibits 1-3 attached.

EXHIBIT 1

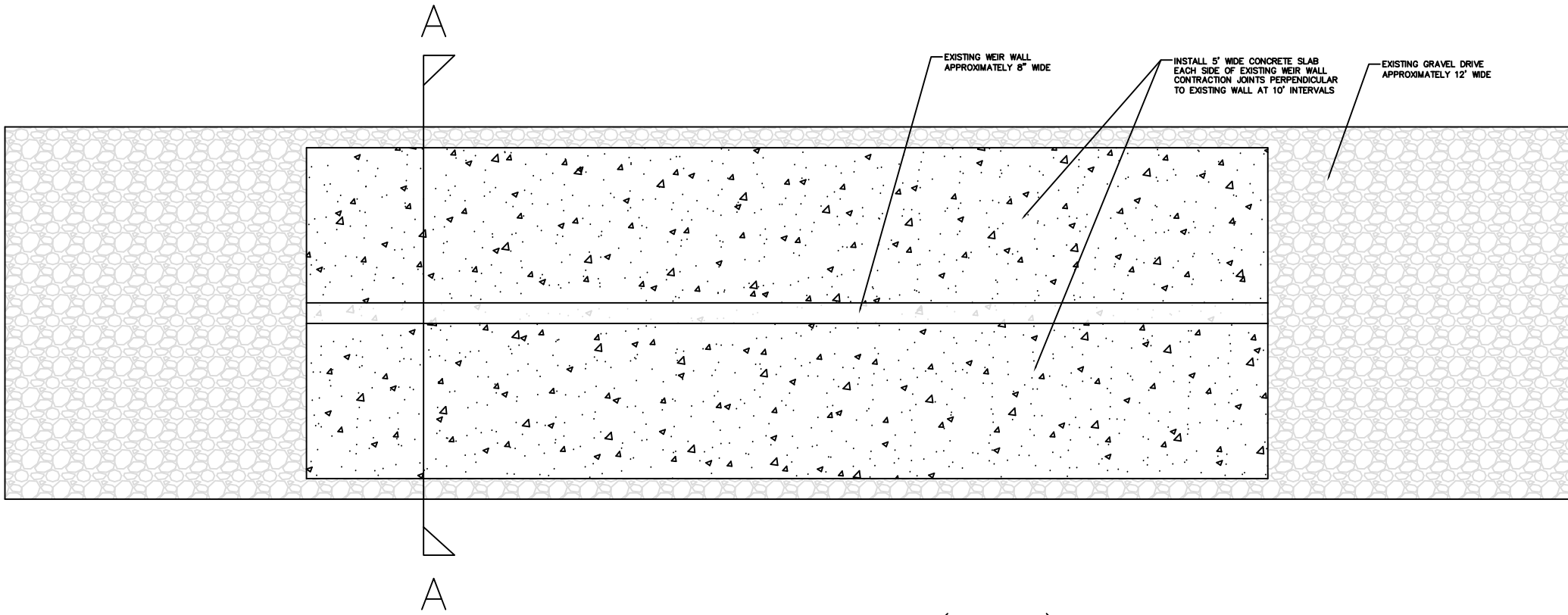

PLAN VIEW (NTS)

EXHIBIT 2

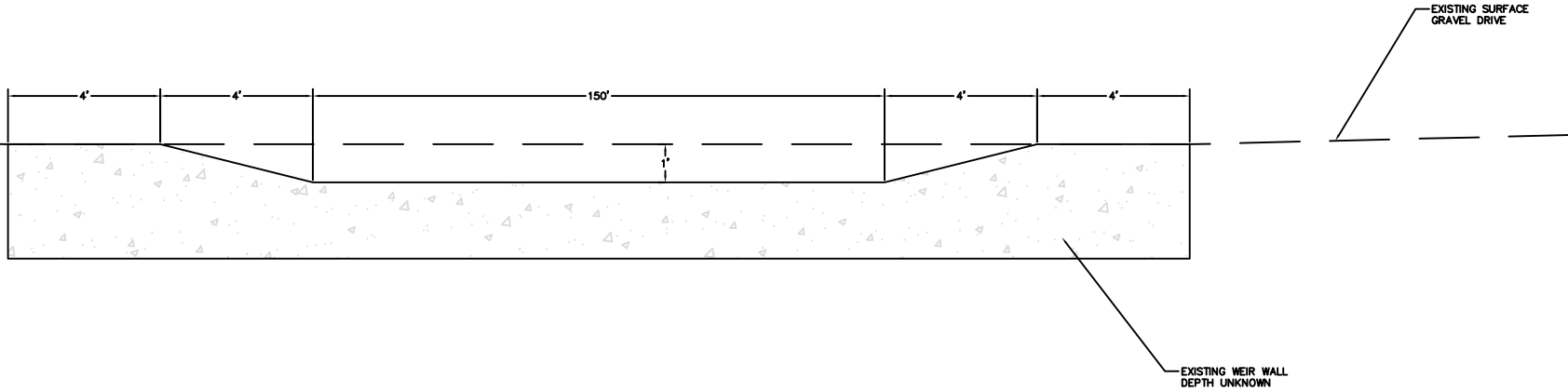

PROFILE VIEW (NTS)

EXHIBIT 3

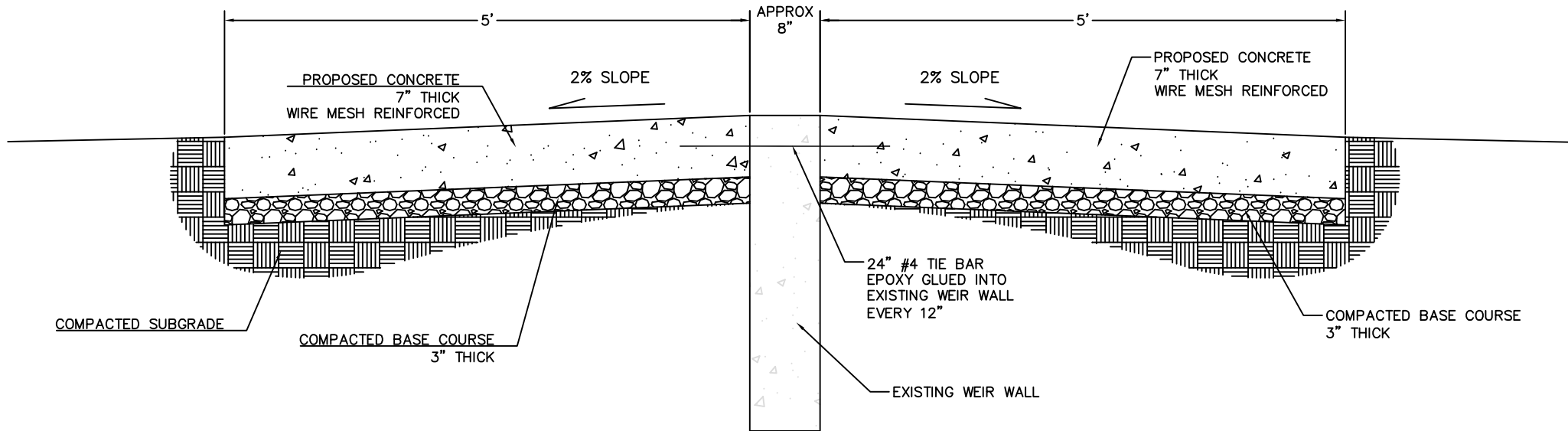

SECTION A-A (NTS)